

| Tevac Part Number | D | H | T | R | Y | X |
|-------------------|---------|-----------|------------|--------|-------|-------|
| | PIN DIA | HEAD DIA. | HEAD THICK | RADIUS | THICK | WIDTH |
| EB-043- | 4 | 8 | 3 | 0,3 | 1,0 | 3,5 |
| EB-044- | 4 | 8 | 3 | 0,3 | 1,2 | 3,5 |
| EB-055- | 5 | 10 | 3 | 0,3 | 1,5 | 4,5 |
| EB-064- | 6 | 12 | 5 | 0,5 | 1,2 | 5,5 |
| EB-065- | 6 | 12 | 5 | 0,5 | 1,5 | 5,5 |
| EB-067- | 6 | 12 | 5 | 0,5 | 2,0 | 5,5 |
| EB-084- | 8 | 14 | 5 | 0,5 | 1,2 | 7,5 |
| EB-085- | 8 | 14 | 5 | 0,5 | 1,5 | 7,5 |
| EB-087- | 8 | 14 | 5 | 0,5 | 2,0 | 7,5 |
| EB-105- | 10 | 16 | 5 | 0,5 | 1,5 | 9,5 |
| EB-107- | 10 | 16 | 5 | 0,5 | 2,0 | 9,5 |
| EB-127- | 12 | 20 | 7 | 0,8 | 2,0 | 11,5 |
| EB-129- | 12 | 20 | 7 | 0,8 | 2,5 | 11,5 |
| EB-167- | 16 | 22 | 7 | 0,8 | 2,0 | 15,5 |
| EB-169- | 16 | 22 | 7 | 0,8 | 2,5 | 15,5 |

For Correct Product, order by Part Number followed by the "L" dimension.

Example:

EB-129-200 for a 12mm dia x 200mm Long Blade.

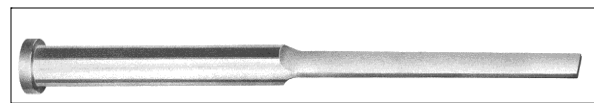

TEVAC Ejector Blades are Manufactured from the highest Quality tool steel to exacting Standards, resulting in a through hardened blade that:

- Has a high core strength, allowing flexing without damage to the blade ejector or the mold.
- Virtually eliminates the possibility of chipping
- Allows blade dimensions to be changed (forming of ends) without affecting hardness.
- Material AISI: 01 (1.2516)

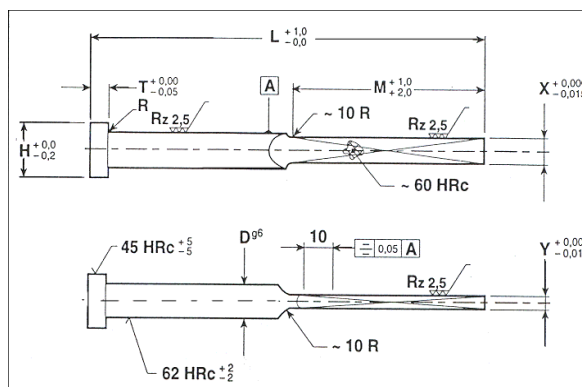

Overall Length/Shoulder Length

- L= 60/30mm
- L= 80/40mm
- L= 100/50mm
- L= 125/60mm
- L= 160/80mm
- L= 200/100mm
- L= 250/125mm
- L= 315/160mm
- L= 400/200mm

| Tevac Part Number | D | H | T |
|-------------------|------|-------|------|
| MM-6- | 1/8 | 1/4 | 1/8 |
| MM-8- | 5/32 | 9/32 | 5/32 |
| MM-10- | 3/16 | 3/8 | 3/16 |
| MM-12- | 7/32 | 13/32 | 3/16 |
| MM-14- | 1/4 | 7/16 | 3/16 |
| MM-16- | 9/32 | 7/16 | 1/4 |
| MM-18- | 5/16 | 1/2 | 1/4 |
| MM-22- | 3/8 | 5/8 | 1/4 |
| MM-24- | 7/16 | 11/16 | 1/4 |
| MM-26- | 1/2 | 3/4 | 1/4 |
| MM-27- | 9/16 | 13/16 | 1/4 |
| MM-28- | 5/8 | 7/8 | 1/4 |
| MM-30- | 3/4 | 1" | 1/4 |

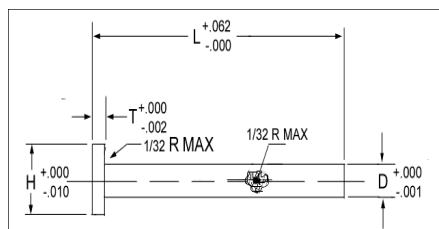

TEVAC moldMAX® Pins



moldMAX® pins from TEVAC offers the highest combination of thermal conductivity and strength available. Made from prehardened moldMAX® copper alloy, our pins are 3 times stronger than competing copper alloy pins, and have thermal conductivity 3-5 times greater than steel pins.

The high strength provides longer life, resistance to abrasion and ease of machining. The high thermal conductivity provides faster heat removal from critical areas, reducing molded part cost and post-mold shrinkage. The high-copper alloy provides excellent corrosion resistance and inherent lubricity and galling resistance.

Length

- L= 4"
- L= 8"
- L= 12"
- L= 18"

CUSTOM SIZES ARE AVAILABLE.

For correct product, order by Catalog Number followed by "L" length.

Example: MM-18-L12

moldMAX® is a registered trademark

SAFE HANDLING: Moldmax in solid form poses no special health risk. Like many industrial materials, beryllium-containing materials may pose a health risk if recommended safe handling practices are not followed. Inhalation of airborne beryllium may cause a serious lung disorder in susceptible individuals. The Occupational Safety and Health Administration (OSHA) has set mandatory limits on occupational respiratory exposures. MSDS sheets are available upon request.